

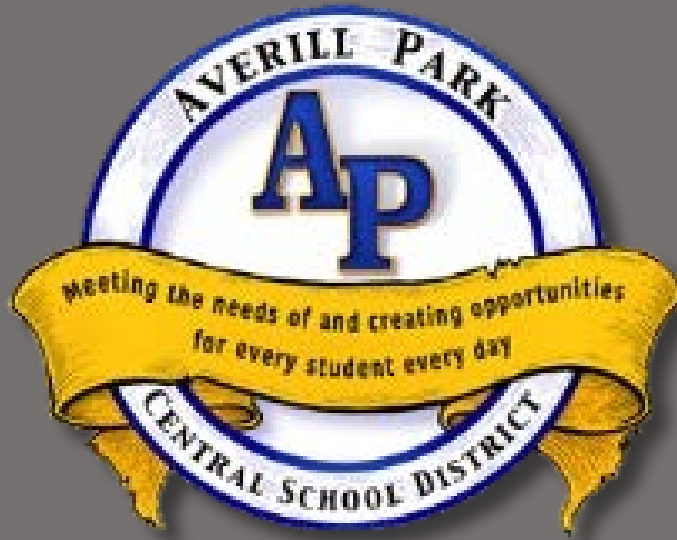

MOSAIC  
ASSOCIATES

---

Saratoga Project Management



**Every Student, Every Day**  
Safety, Security, Accessibility, Opportunity

July 8, 2021  
Board of Education Presentation  
Capital Project 2021



## Agenda

- Project Design Scope
- Estimated Project Cost
- Referendum Schedule



## Priority Items(Revised) – Previously Labeled Add Alternate Items

- High School
  - 300 Wing - Moisture issues
  - Bus Atrium – Heating
  - Emergency Generator
- Algonquin Middle School
  - Courtyards – repair window heads
- Poestenkill ES
  - Cafeteria – replace upper windows
  - Cafeteria – potential wall movement



## Priority Items

- Security Vestibules
- Building Condition Survey (BCS)
- Administrative Team
  - Scope selected by building administrative team that requires addressing in the project
- Facilities Team
  - Scope selected by facilities department team that requires addressing in the project



## Current Project Cost Estimate

• Priority Items (Revised):	\$ 2,740,000
• Priority Items:	\$ 25,787,000
• Total :	<hr/> \$28,527,000

- Priority Items (Revised) – Previously labeled “Add Alternate Items”. Per June 14<sup>th</sup> BOE Meeting, the items labeled “Add Alternates” will be considered “Priority Items”.



## Project Timeline | Next Steps

Item	Date(s)
Board of Education - Finalize Scope	July 8, 2021
Board of Education Resolution to Set Vote Date	July 14, 2021
Public Communication	July – October 2021
<b>Referendum Vote</b>	<b>October 12, 2021</b> <b>7:00am – 9:00pm</b>



Design and SED Approval Schedule	October 2021 – September 2023
Construction and Closeout Schedule	June 2022 – December 2026

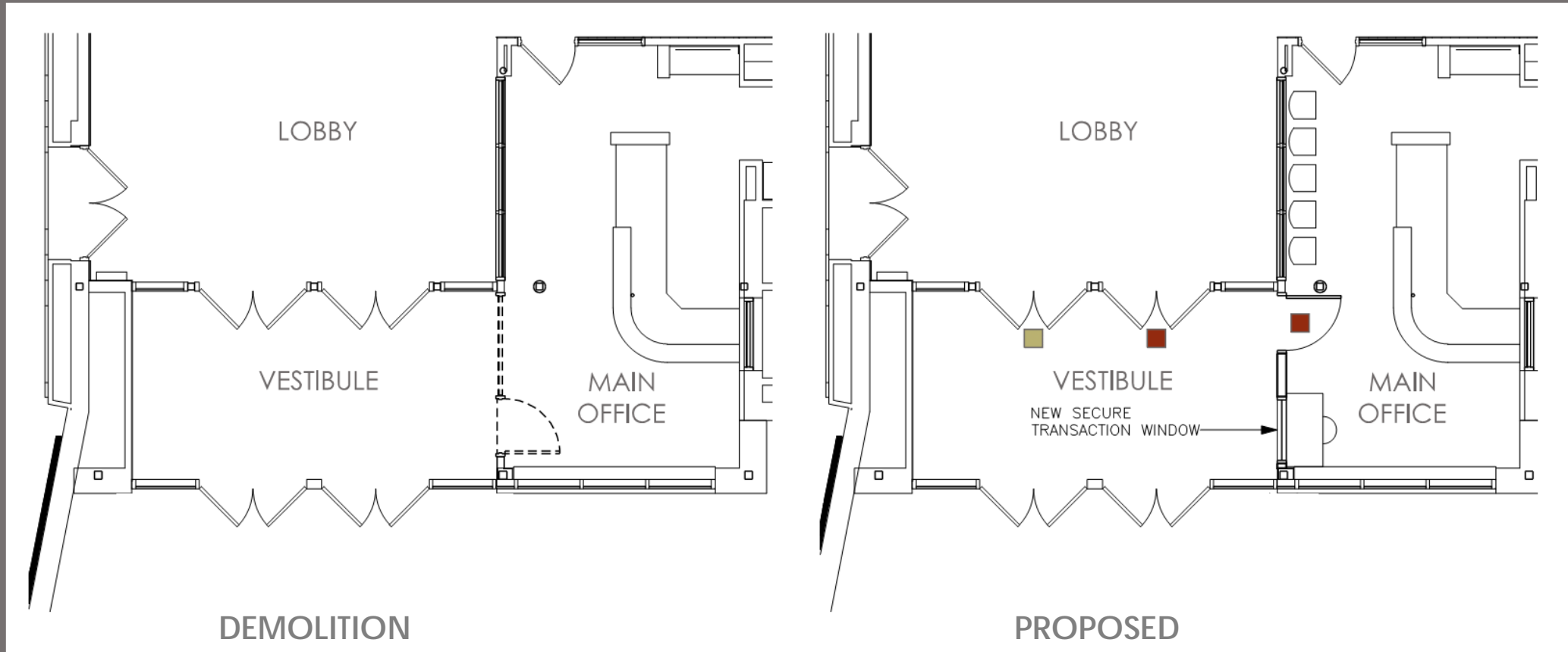

# Secure Vestibule | Averill Park High School



Legend:

-  Card Reader Access
-  Electronic Release Latch
-  Addition



# Secure Vestibule | Algonquin Middle School

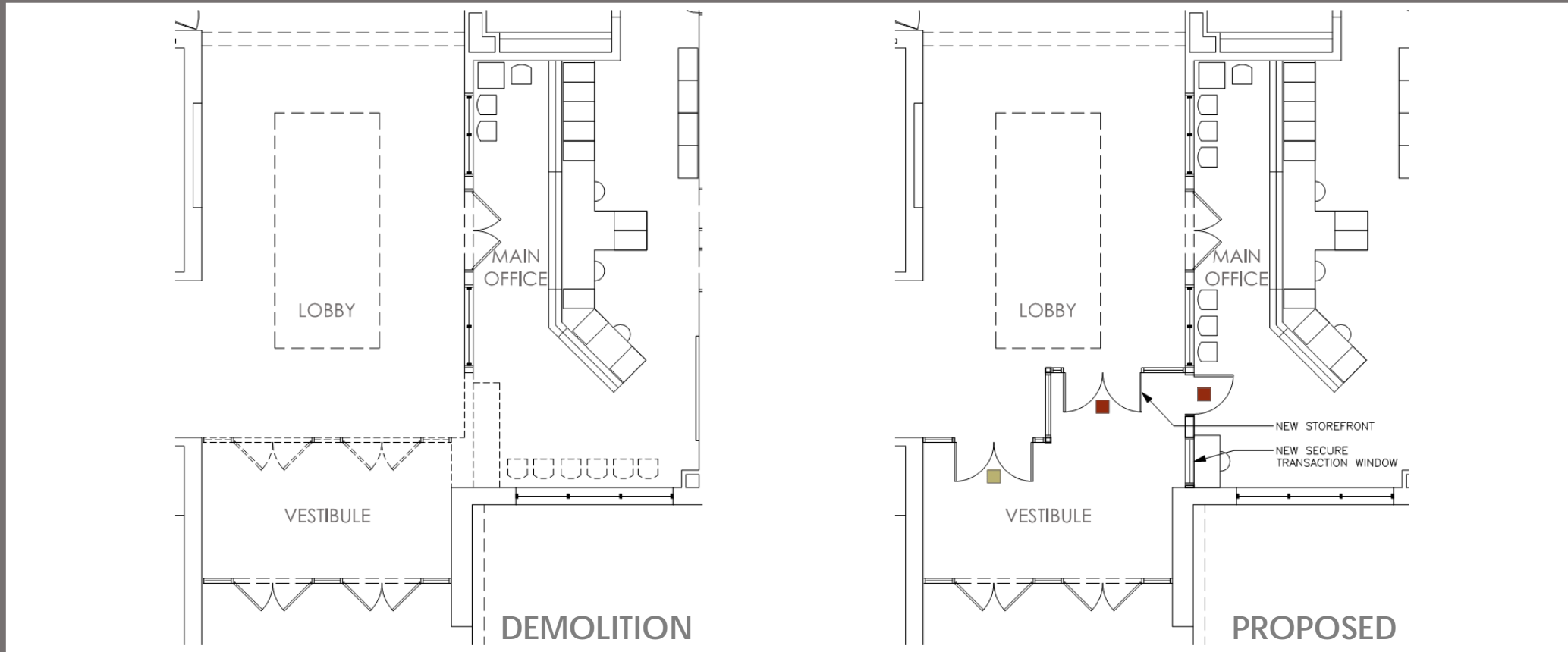

Legend:



Card Reader Access



Electronic Release Latch



Addition





# Secure Vestibule | George Washington

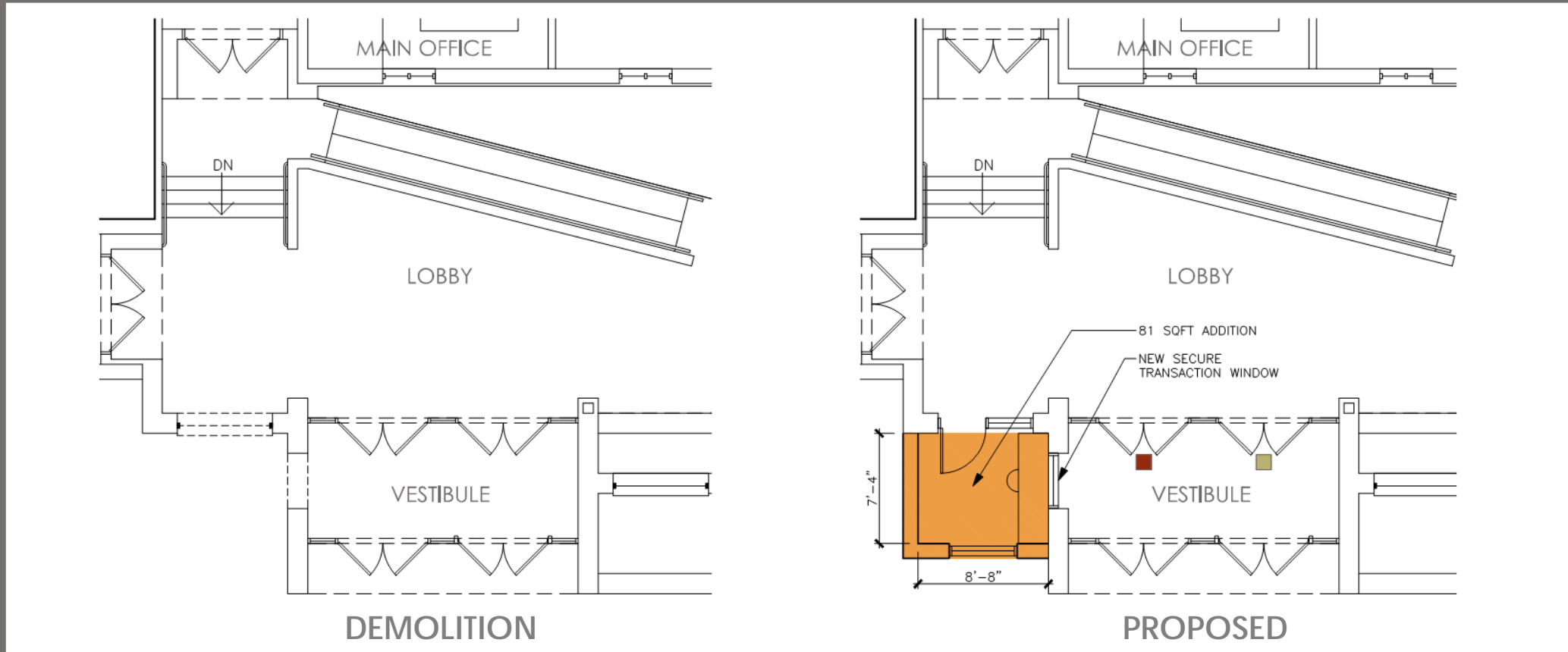

Legend:



Card Reader Access



Electronic Release Latch



Addition



# Secure Vestibule | Miller Hill Elementary

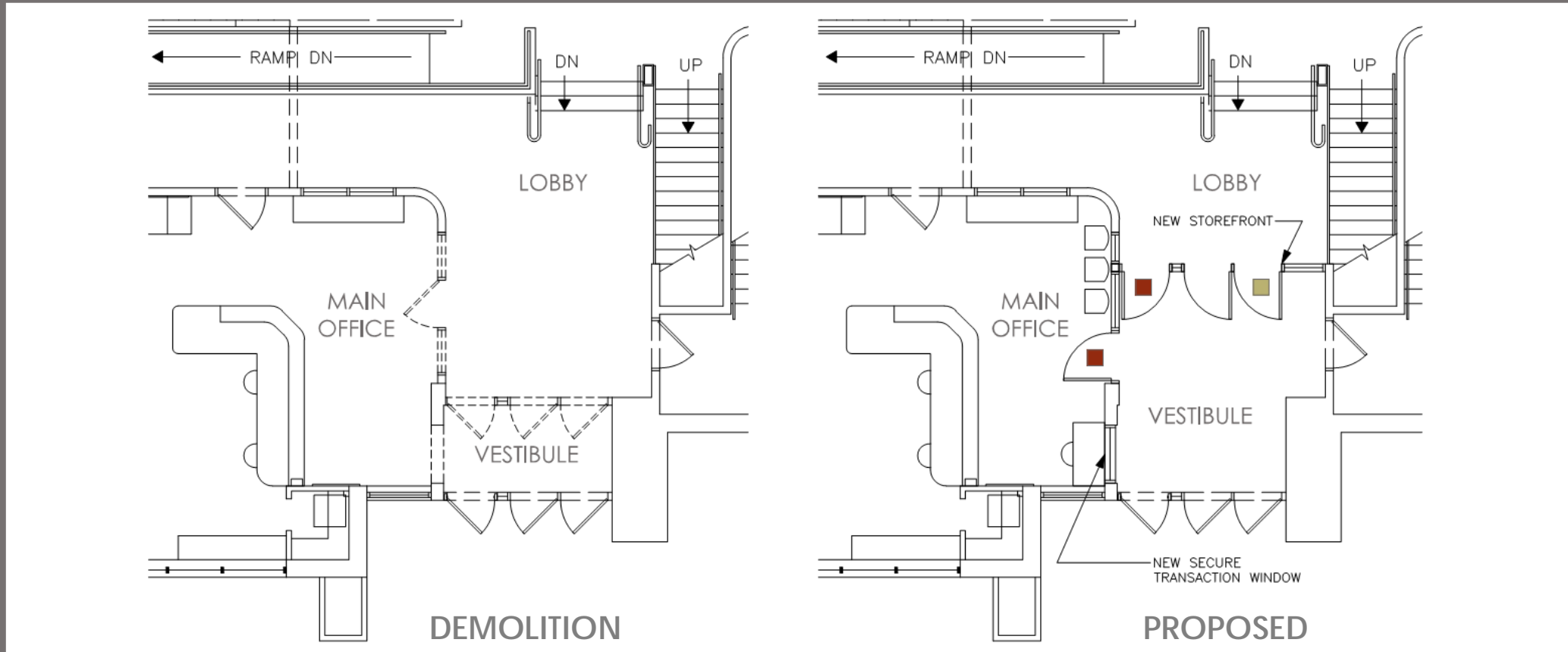

Legend:



Card Reader Access



Electronic Release Latch



Addition



# Secure Vestibule | Poestenkill Elementary

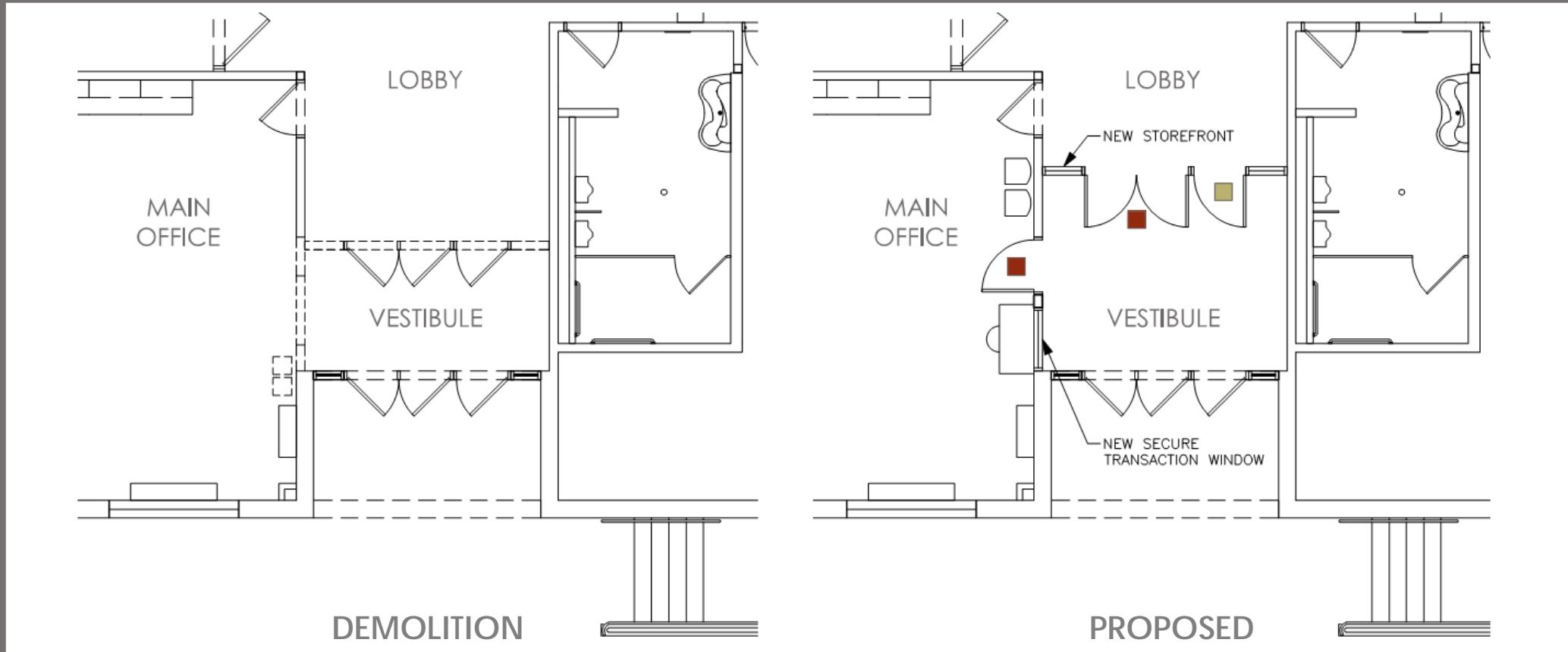

Legend:



Card Reader Access



Electronic Release Latch



Addition



# Secure Vestibule | West Sand Lake Elementary

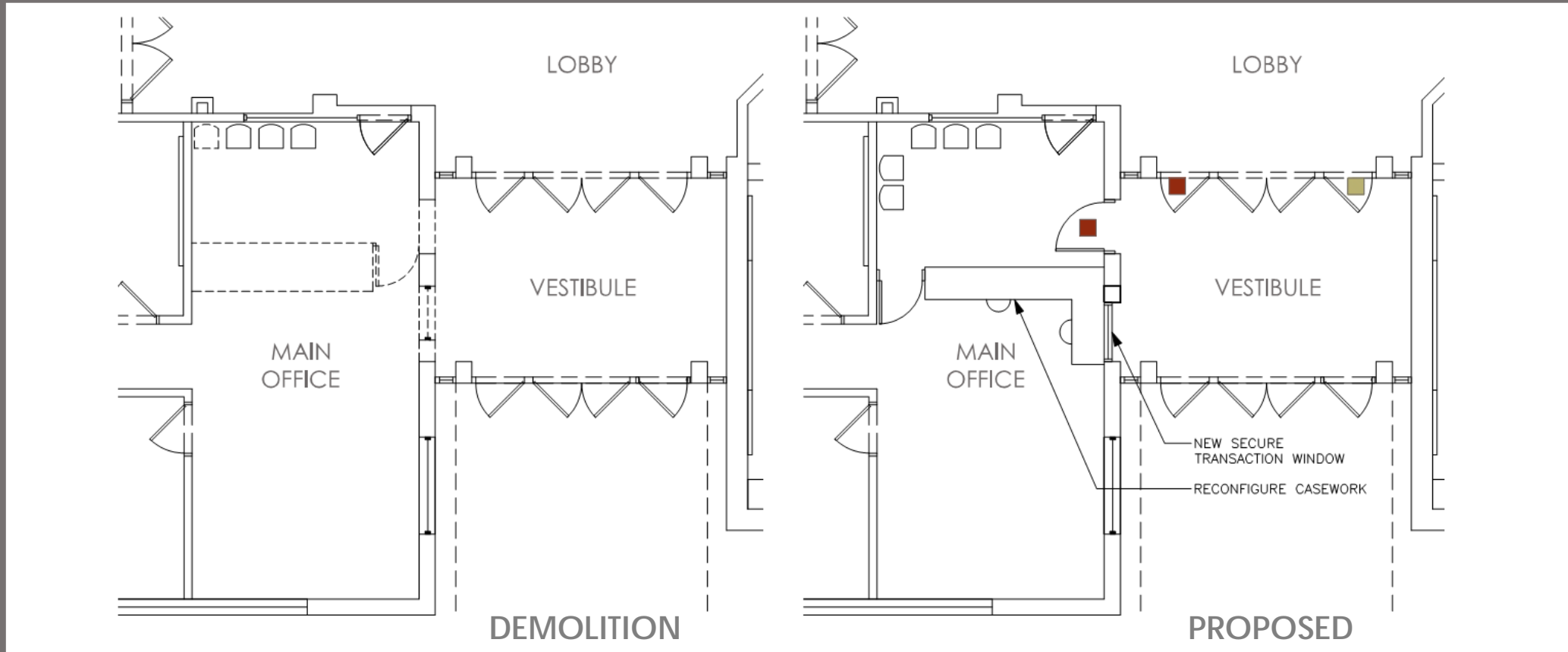

Legend:



Card Reader Access



Electronic Release Latch



Addition



## Building Condition Survey (BCS)

- Critical building maintenance items, including:
  - Fire alarm replacements
  - Roofing replacements
  - Kitchen equipment upgrades/replacements
  - Heating and ventilating system upgrades
  - Electrical upgrades
  - Masonry restoration



## Building Condition Survey (BCS)



Electrical upgrades and various system replacements at multiple buildings



Boiler, water system, and circulating pump replacements at multiple buildings



Roofing replacements at various buildings to address leaks, moisture issues, and warranties



## Building Condition Survey (BCS)



Chimney re-pointing and cap repairs at multiple buildings



Slate roof repairs, soffit repairs, and masonry restoration at West Sand Lake

Thank You